

# STEP by STEP INSTALLATION GUIDE



**AEOLUS | M3**  
1201  
Case & Radiator Fan

Package Contents

**A**

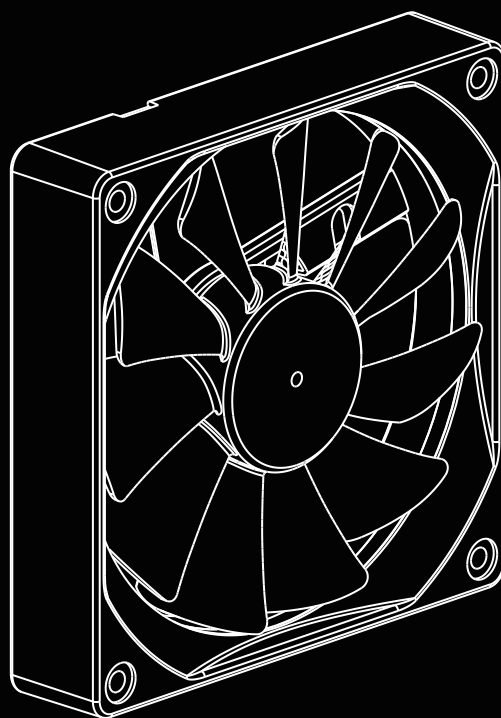

**X1**

**B**



**X4**

# 01

Turn off the computer before installing

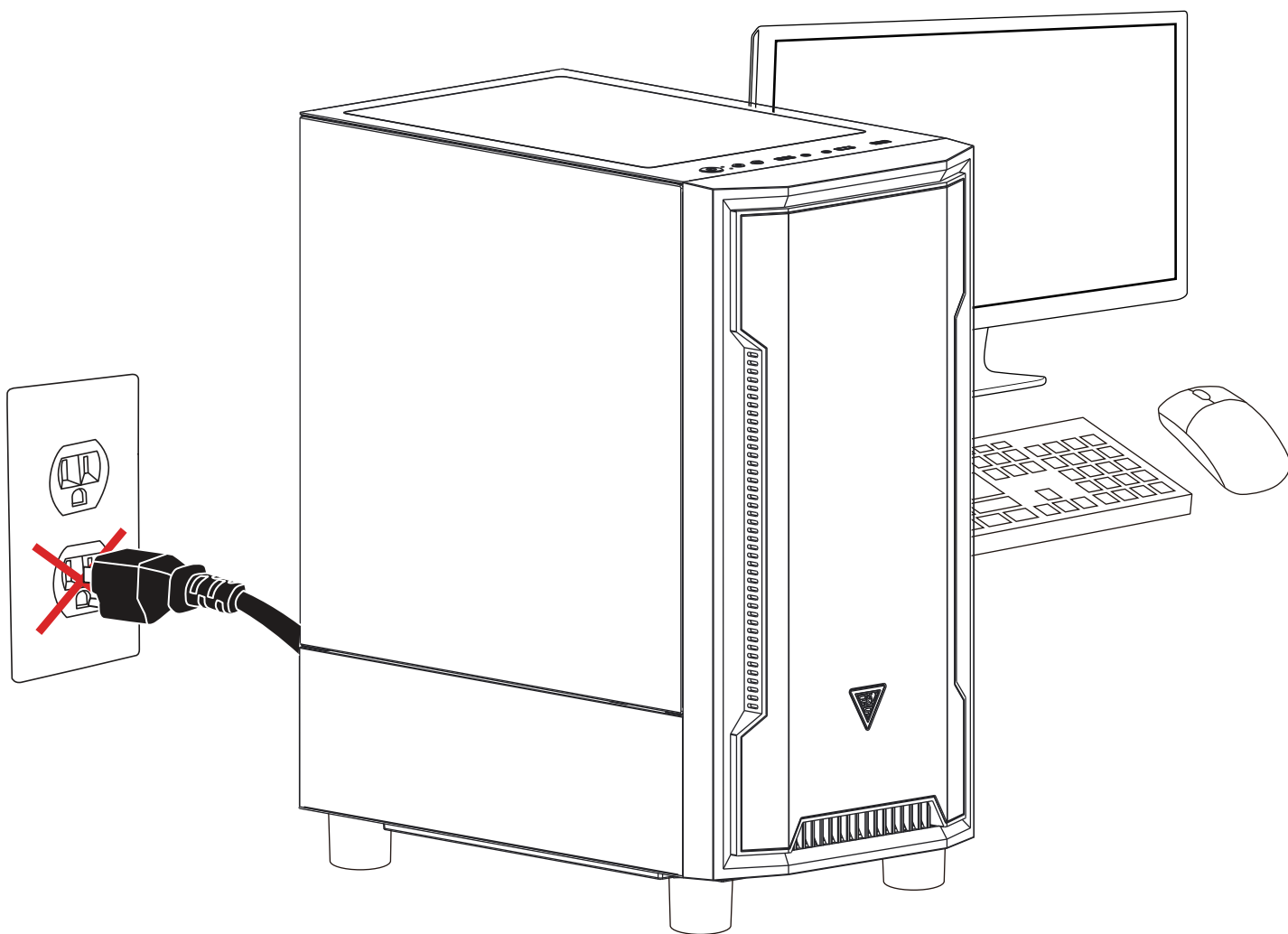

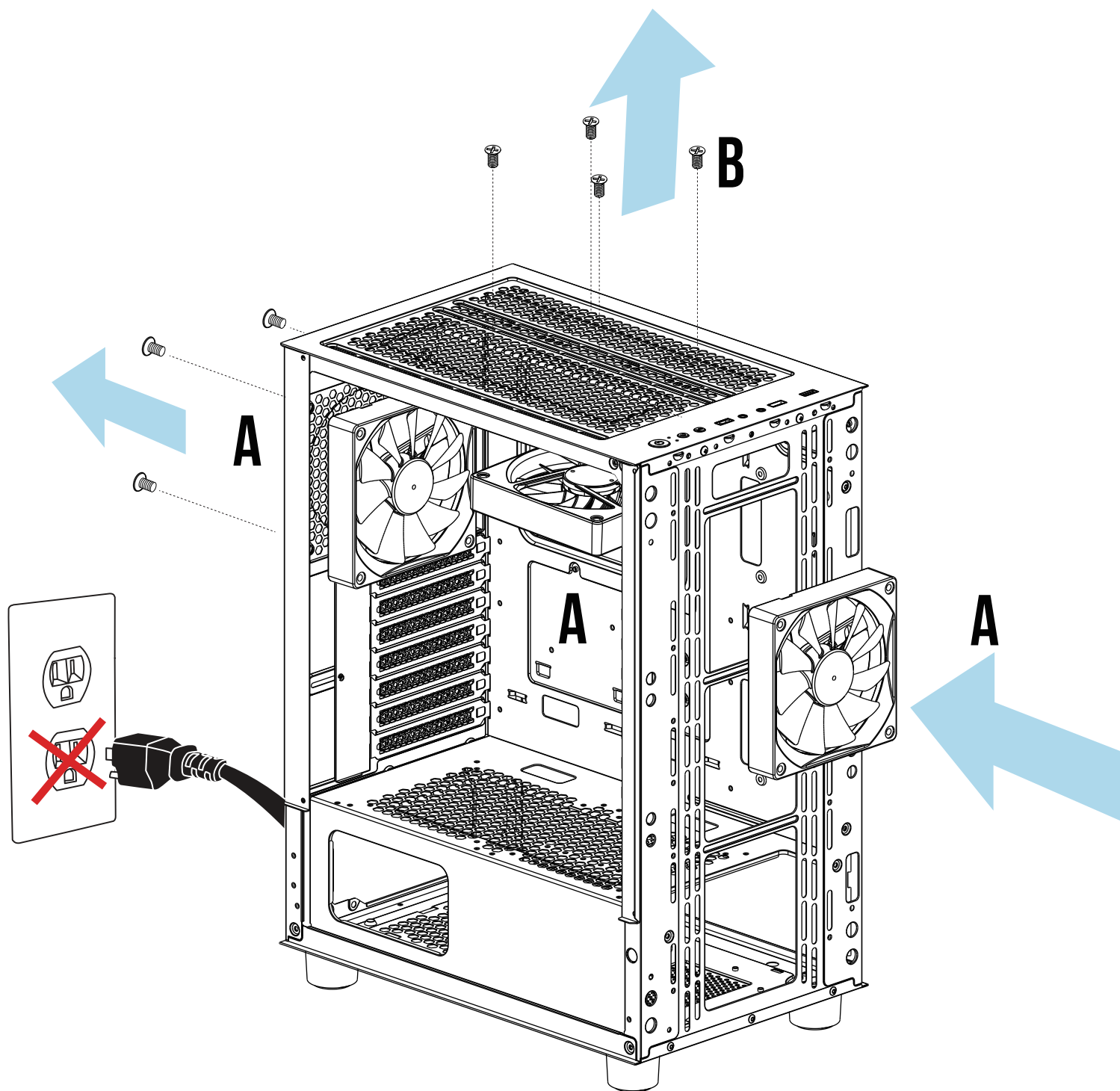

# 03

Two methods to control build-in RGB Lighting  
Method 1. Use included button

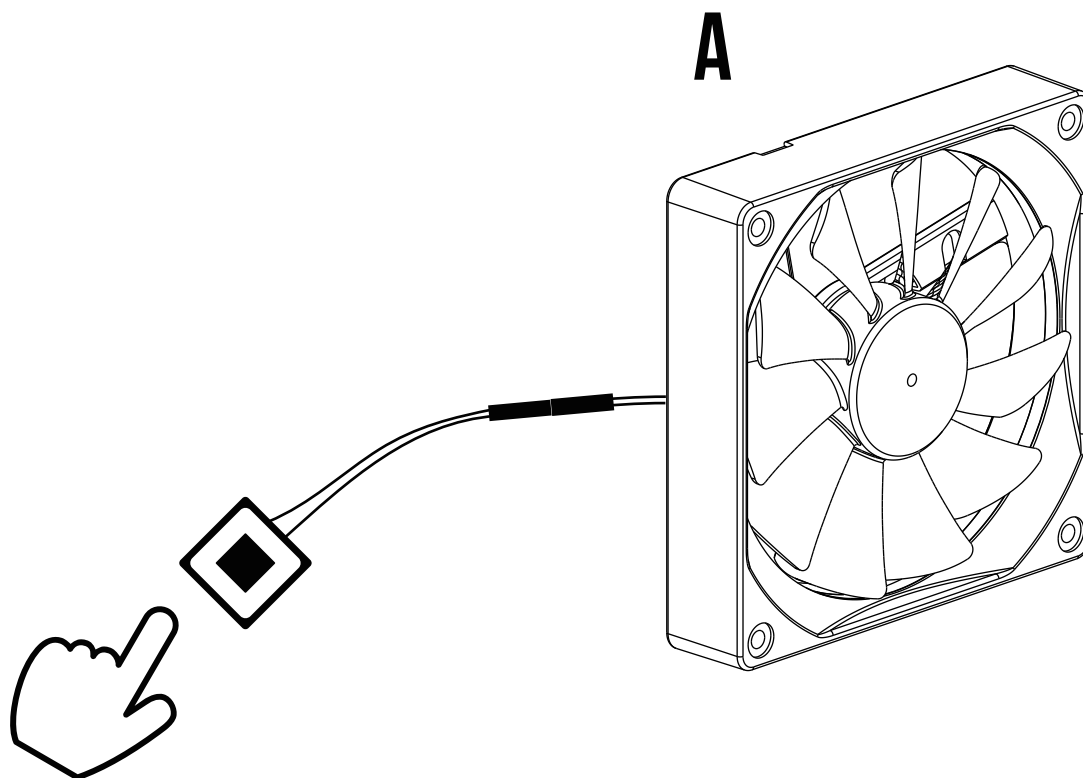

If the motherboard RGB sync function is used, the button function will be automatically disabled.

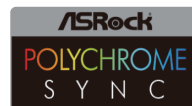

Manual is for reference only. Actual product may vary.

# 04

Two methods to control build-in RGB Lighting  
Method 2. If your case has "RESET SW", you can use case button to change lighting modes

## 1

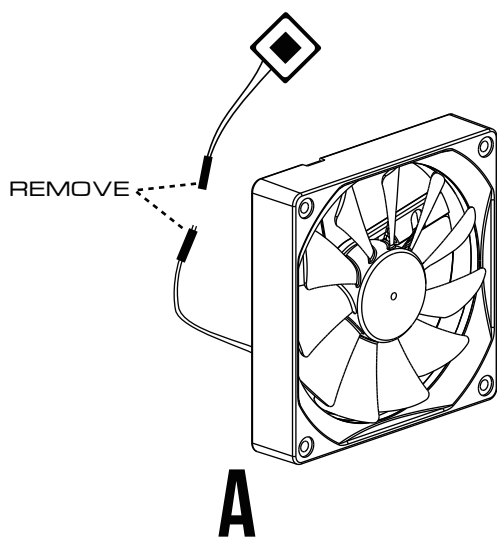

## 2

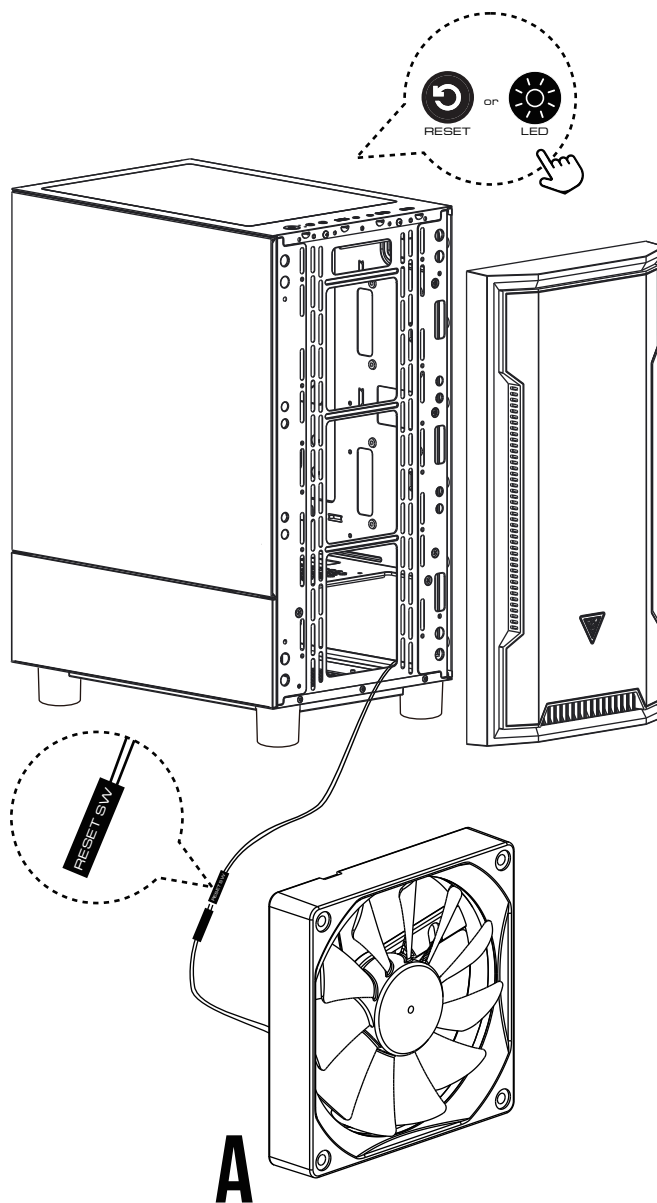

If the motherboard RGB sync function is used, the button function will be automatically disabled.



# 05

If your motherboard has 5V 3-Pin addressable (digital) RGB header, you can customize RGB lighting via motherboard manufacture sync software

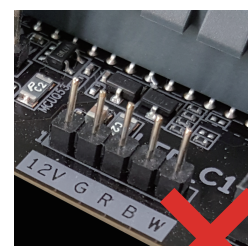
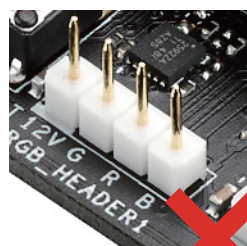
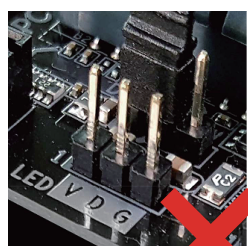
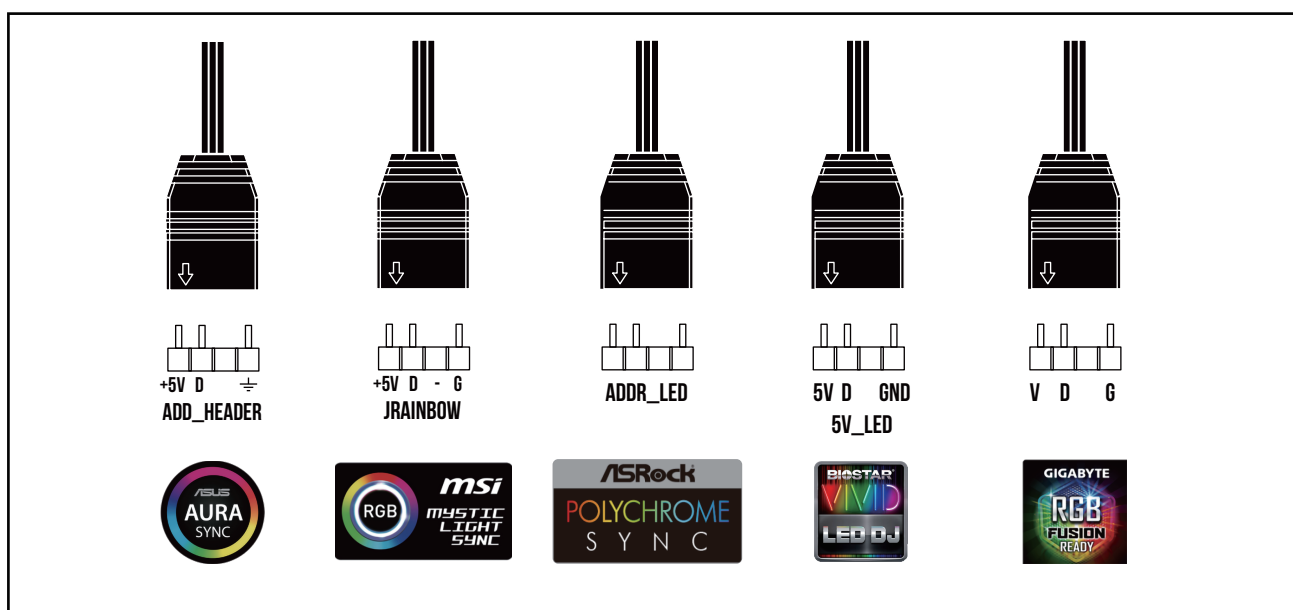
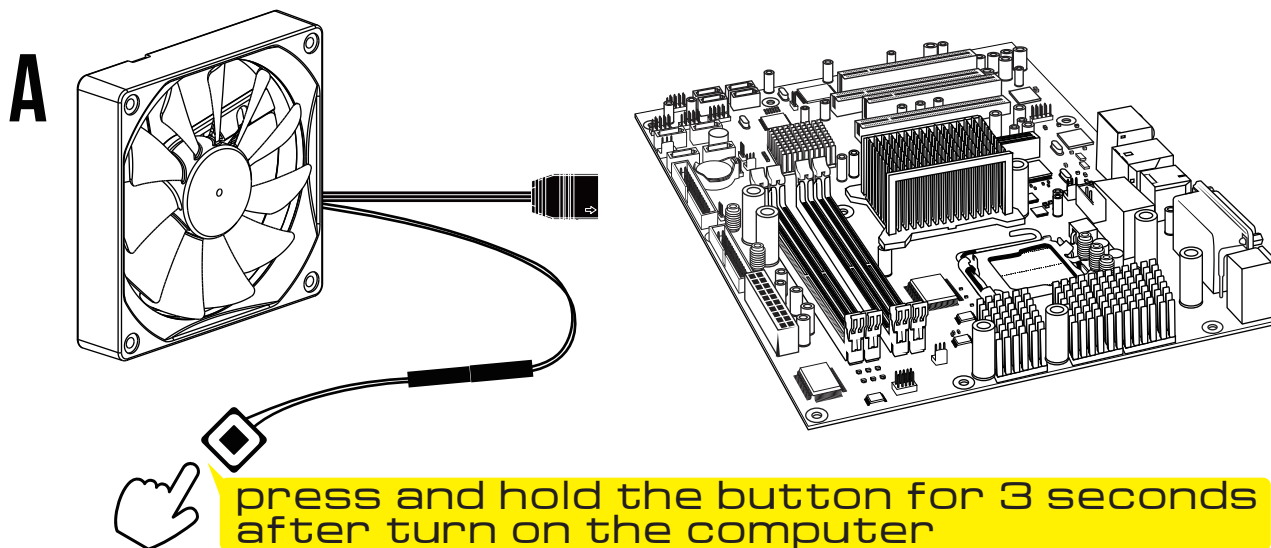

AEOLUS M3-1201 only support 5V addressable (digital) RGB header  
Manual is for reference only. Actual product may vary.

# 06

The design of male and female motherboard sync connectors to deal with insufficient 5V socket

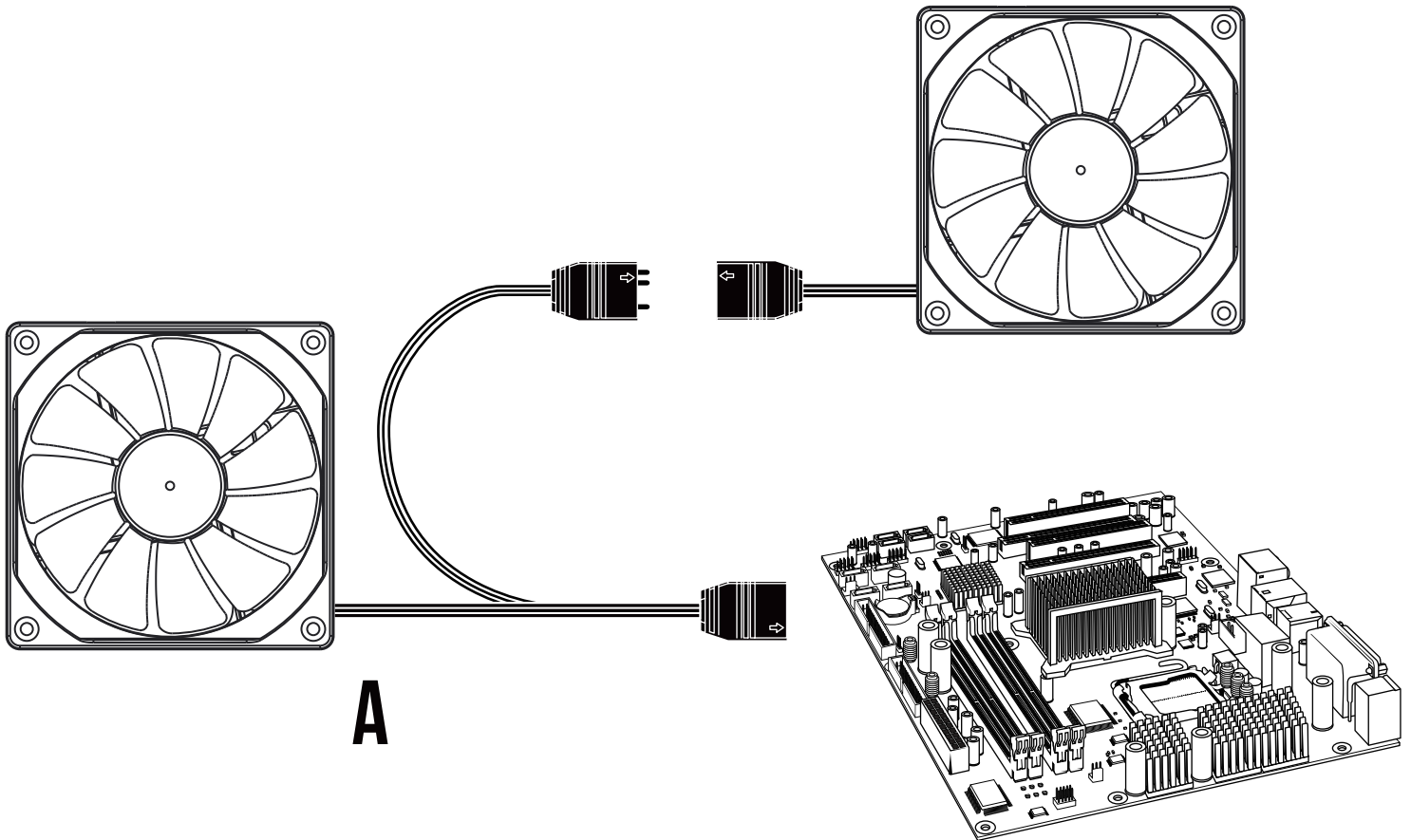

Only support 5V addressable (digital) LED



GAMDIAS

GAMING ART IN MOTION

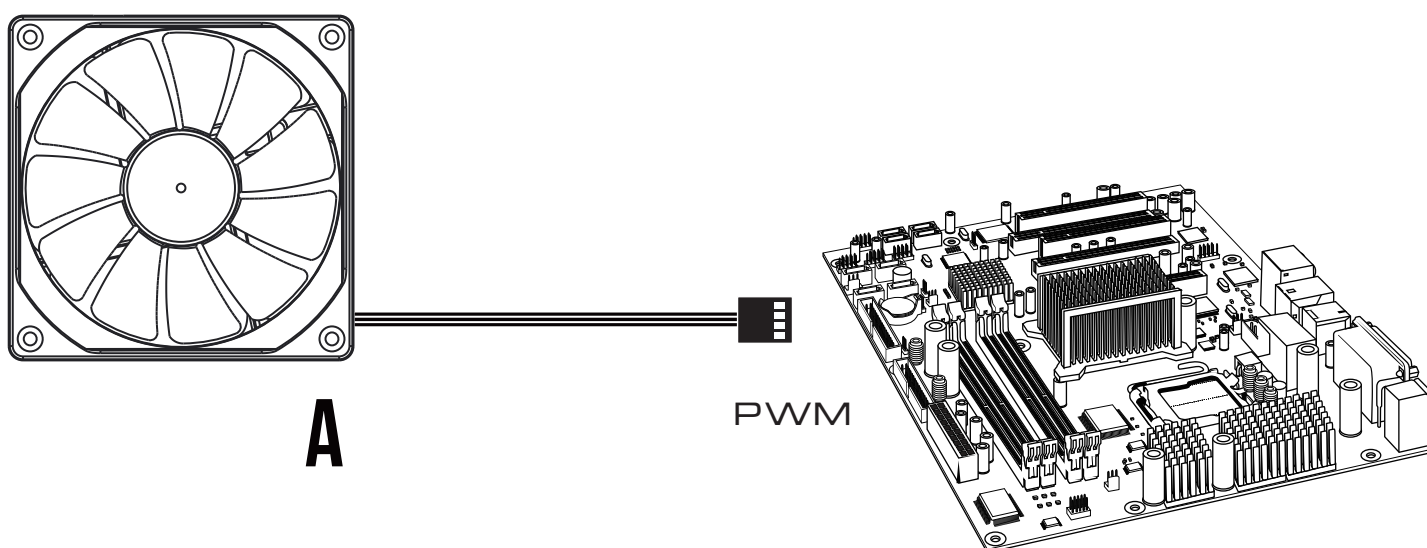

Only support 5V addressable (digital) LED